



Jelly Belly® Bean Machine Operating Instructions

To Fill Machine:

Unscrew the *screw plug (1)* and remove the *cap (2)*. Pour Jelly Belly beans into *glass globe (6)*.

Caution: Once screw is removed, the base plate (11) can be separated from machine body (10) if lifted up.

To Remove Glass Globe:

Remove *screw plug (1)*, *cap (2)*, *nut (3)* and *spider retaining ring (4)*, and carefully remove *glass globe (6)*. To replace *glass globe (6)*, reverse this procedure.

Caution: Finger tighten *nut (3)* and *screw plug (1)* to avoid excessive pressure on *glass globe (6)*.

To Remove Coin Mechanism:

Remove *screw plug (1)*, *cap (2)*, *nut (3)*, *spider retaining ring (4)*, *glass globe (6)*, *gasket (7)*, *brush plate (8)*, and *wheel (9)*. Grasp top of *coin mechanism (12)* and slide/lift upward from its position. Remove screw at E (see drawing below) to dispense beans without using coins. To reassemble, replace parts in reverse order.

Jelly Belly® is a registered trademark of Jelly Belly Candy Company, U.S.A.

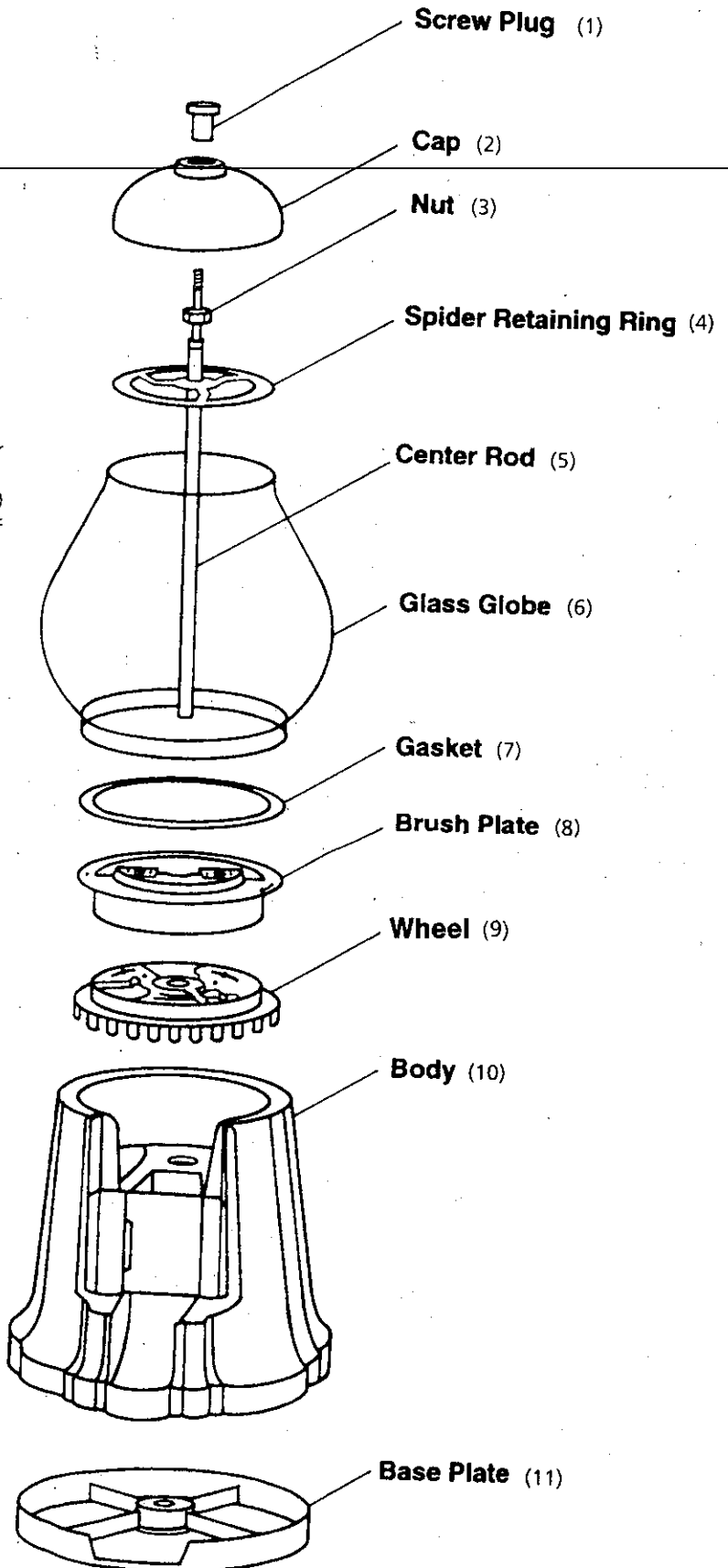

Coin Mechanism (12)

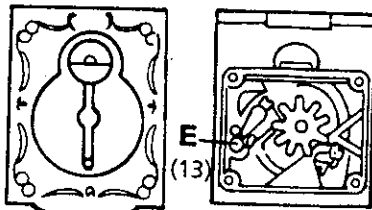

Front
(14)

Back
(15)